



Adventures in Learning—Spring Session 2014

Registration: \$60 if paid by March 19th, \$65 after March 19.

Fees are nonrefundable. You may attend as many classes as you like in these eight weeks for one registration fee!

Lunch Fee: \$8/week or \$60/eight weeks OR bring your own lunch and get a beverage and dessert for \$3.

Lunch reservations need to be made and paid **in advance by Friday noon.**

~ 8:15—8:45 am ~

Blood Pressure Check in the North Hallway
by Wichita Parish Nurse Ministry. Please
allow enough time so everyone can get to class.
Jette Mortensen, R.N., Parish Nurse
Coffee and Conversation in the Lobby

~ 9:00—9:50 am ~

TRAVEL

- Mar. 25** “Vancouver to Fairbanks, Alaska”
Gerald and Diane Schmitt, Members, AARP
- Apr. 1** “Australia and New Zealand”
Ron and Susan Rathgeber, Retired
- Apr. 8** “Changing the Way You See the World”
Lottie Miller, Friendship Force of Kansas, Inc.
- Apr. 15** “London—A Photo Tour”
Sara Jones, Educator, Businesswoman, Retired
- Apr. 22** “Another View of Haiti”
Frantz Casimir, Student, WSU
- Apr. 29** “Lutherland: Tour of Germany”
Paul Reimers, Lutheran Pastor, ELCA, Retired
- May 6** “Trip to Israel”
Wayne Mason, Radiologist, Retired
- May 13** “Australian Outback”
Phillip Hughes, Native Australian

HEALTH

- Mar. 25** “Get Heart Healthy by Touching the
Lives of Others”
Denise Faught, Volunteer Coordinator, Amedisys
Hospice Services
- Apr. 1** “Three Angels Community Health and
Education Center”
Sherlyn Bryant, Representative, Three Angels
Community Health & Education Center
- Apr. 8** “What’s All This Mean?—Medical Jargon
Explained”
Todd Alstatt, Community Liaison, ComfortCare
Homes, Inc.
- Apr. 15** “Aromatherapy and Digestion”
Richard Caldwell, Teacher, Retired

~ 9:00—9:50 am ~

- Apr. 22** “Hunter Health Clinic and Diabetes Education”
Becky Jones, Representative, Hunter Health Clinic,
Outreach Clinic
- Apr. 29** “Center for Health and Wellness”
Davna Gould, Center for Health and Wellness
- May 6** “Hospice Facts/Fiction and the Need for
Volunteers”
Randall Turner, Mgr. of Volunteer Services; Mark
Davis, Hospice Care Consultant; Cathy Parry-Jones,
Volunteer Coordinator; Harden Hospice—KS/MO
- May 13** “Acupuncture”
Jill Bergkamp-Engle, D.C., Bergkamp Chiropractic &
Massage

~ 9:00-11:15 am ~

BRIDGE CONVENTIONS

- Mar. 25—May 13** A class targeting bridge play-
ers who wish to learn basic conventions with an eye
to playing duplicate contract bridge. Regular partners
welcome. Limit: 8
Alan Phares, American Contract Bridge Life Master

~ 10:00-10:50 am ~

RELIGION

- Mar. 25—May 13** “The Gospel of John”
Rev. Paul Reimers, Lutheran Pastor, ELCA, Retired
- Mar. 25** “Ch 12 : Mary Anoints Jesus’ Feet, Palm
Sunday”
- Apr. 1** “Ch 13-14: Jesus Washes the Disciples’
Feet, Gives New Commandment to Love”
- Apr. 8** “Ch 15-16: Jesus Says, ‘I Am the Vine, You
are the Branches,’ Holy Spirit as Counselor”
- Apr. 15** “Ch 17: Jesus’ High Priestly Prayer: All
Be One”
- Apr. 22** “Ch 18: The Arrest and Trial, Peter’s Denial”
- Apr. 29** “Ch 19: The Crucifixion of Jesus”
- May 6** “Ch 20: The Resurrection of Jesus Christ:
Easter Morning”
- May 13** “Ch 21: The Risen Christ on the Seashore”

~ 10:00-10:50 am ~

HISTORY

- Mar. 25** "Dr. Charles Ohiyea Eastman: Great Plains Indians' Nonviolent Resistance to Being Colonized"
Gretchen Eick, Ph.D., Professor of History Emeritus, Author
- Apr. 1** "A Miracle 121 Years in the Making: the McPherson Opera House"
John Holecek, Exec. Director, McPherson Opera House
- Apr. 8** "Kansas Brewers and Breweries" *see p. 3
Cindy Higgins, Author, KS Historian & Journalist, Kansas Humanities Council
- Apr. 15** "JFK's Assassination Is Not a Mystery, Part 2"
Carl Williams, Motion Picture Writer/Director for the Pentagon, Retired
- Apr. 22** "Social Changes WE Have Seen"
Larry Heck, Sociology Professor, Newman University
- Apr. 29** "Assorted Songs of World War II"
Richard Caldwell, Teacher, Historian, Retired
- May 6** "Cleopatra's Poison: Femme Fatale or Pharmacist?"
Cheryl Golden, Ancient History Professor, Newman University
- May 13** "100th Anniversary of the Outbreak of World War I"
John Dreifort, Ph.D., Professor of History, WSU

SING!

- Mar. 25—May 13** "Singing for Fun"
Glennycce Reimers, Parish Choir Director, Reformation Lutheran Church

POETRY

- Mar. 25—May 13** "Poetry"
Roy Beckemeyer, Poet

~ 11:00—11:50 am ~

POTPOURRI

- Mar. 25** "Wichita Festivals/River Festival 2014"
Mary Beth Jarvis, President/CEO, Wichita Festivals, Inc.
- Apr. 1** "Online Education"
Joe Compton, Director of Academic Affairs, Univ. of Phoenix
- Apr. 8** "Lessons from the German Fulbright Experience"
Randy Bush, International Student Advisor, Butler Co. Community College

~ 11:00—11:50 am ~

- Apr. 15** "History and Stories of the Hillcrest"
Dudley Toevs, Teacher, Author, Soloist, Retired
- Apr. 22** "Goodwill Industries of Kansas"
Emily Compton, President, CEO
- Apr. 29** "Junior ROTC at Derby High School"
Colonel Dillard, Junior ROTC, Derby
- May 6** "The Smart Way to Buy a Car"
Renee Higgins, Dir. of e-Commerce, Davis-Moore
- May 13** "Upward Bound: Motivating Students"
Kaye Monk-Morgan, Director, Upward Bound, WSU

PERSONAL STORIES

- Mar. 25** "Preserving Your Life Story"
Jill Staggs, Personal Historian, Personal Legacy Memoirs
- Apr. 1** "Serving My Country—My Iraq Experience"
Ben Romero, Army Veteran, Sedgwick Co. Deputy
- Apr. 8** "From Grit to Grace"
Lorenne Tippin, Mother of Four, Author, Missionary, Teacher, Retired
- Apr. 15** "Austin's Story: Don't Text and Drive"
Julie & Austin Breitenstein, Mother and Son
- Apr. 22** "Jana's Campaign, Inc."
Nicole Walz, Program Coordinator
- Apr. 29** "I'm Planted in Kansas"
Annie Calovich, Gardening Columnist, Reporter, The Wichita Eagle
- May 6** "My Battle with Severe Depression"
Mark Potter, Head Men's Basketball Coach, Newman University
- May 13** "Our Family Taking Care of Your Family"
Doug Stark, President, Comfort Care Homes

~ 12:00—12:40 LUNCHEON ~

~ 12:45—1:20 pm PROGRAM ~

- Mar. 25** "Remember When: Songs to Trigger Your Memory!"
Lewis Street Singers with Glennycce Reimers, Director
- Apr. 1** "Goat Glands to Ranch Hands (The KFDI Story)"
Orin Friesen, Cowboy, Historian
- Apr. 8** "Music Makes You Feel Better"
Cindy Houston, Owner, Garten's Music and the L.I.F.E. in Kansas MusicMakers
- Apr. 15** "Sky High—Aerial Photography"
Paul Bowen, Photographer, Air to Air
- Apr. 22** "Music Theatre of Wichita: An Exciting Preview of Our 2014 Season"
Wayne Bryan, Producing Artistic Director, Music Theatre of Wichita
- Apr. 29** "Music to Your Ears"
John Paul Johnson, Ph.D., Professor of Music, WSU

~ 12:45—1:20 pm PROGRAM ~

May 6 “Student Unrest in the 60’s—I Was There”

James J. Rhatigan, Ph.D., Dean of Students
Emeritus, WSU; Consultant, WSU

May 13 “All the World’s a Stage: Selected
Scenes and Monologues from Shakespeare”

The Northfield Players, High School Performance Troupe
Bill Coleman, Teacher, Northfield School of Liberal
Arts; Performer; Author; Poet

~ 1:30—2:20 pm ~

RELIGION (Repeat of Morning Session)

Mar. 25—Apr. 29, May 13 “The Gospel of John”

Rev. Paul Reimers, Lutheran Pastor, ELCA, Retired

~ 1:30—2:45 pm ~

GENEALOGY

Mar. 25—May 13 “Intermediate Genealogy”

Judy Hall, Family Historian, English Teacher, Retired
Linda Klingman, Family Researcher, Property Owner/Mgr.
Sara Orr Jones, Genealogy Junkie, Technical College
Instructor, Retired

Mar. 25 “Stumbling Blocks on the Genealogy
Path”

Apr. 1 “What’s Happening with FamilySearch
Online?”

Apr. 8 “How To Go Paperless with Family Tree
Maker & Ancestry.com”

Apr. 15 “Timelines, History and Geography—
A Roadmap for Genealogists”

Apr. 22 “Importance of Collateral Lines in
Increasing Discoveries”

Apr. 29 “Bring Your Questions and We’ll Talk”

May 6 “Share Your Own Secrets, Tips and
Success Stories”

May 13 “Taking the Next Step”

THREADBARE READERS THEATRE

Mar. 25—May 13 Join a fun group rehearsing short
skits and sketches for public presentations.

No memorization is needed but good public reading/
speaking is important.

Judy Oliver, Teacher, Retired

~ 1:30—3:00 pm ~

ART STUDIO

Mar. 25—May 13 “Primarily Watercolor”

This will be a studio class, with students painting
compositions of their own choosing. There will be
short lectures in composition and color theory.
Sharon Leiker, Signature Painter, KS Art Guild;
Member, Wichita Women Artists; KS Academy of
Oil Painters

✿ This History program is brought to you by
the **Kansas Humanities Council**, a nonprofit
organization promoting understanding of the
history and ideas that shape our lives and
strengthen our sense of community. This

presentation is fully sponsored
by the council. Accordingly,
members of the community
are invited to attend for free.



The office would appreciate a call
from non-members who plan to attend.

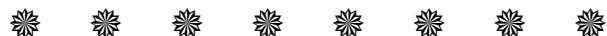

**Scholarships Available for
Spring Session**

LifeVentures has scholarships available for *Adventures in
Learning* through the Bill & Shirley Nail Memorial
Scholarship Fund.

The purpose is to help individuals pay the registration fee
—up to \$30 (or half the fee). Please contact Stacy
Jansson to apply for one of these scholarships.

This fund is separate from the general budget. Donations
honor the Nails and extend our group.



LifeVentures welcomes guests.
You may bring a friend (*first-time
attendee only*) to classes one

Tuesday with no fee. Lunch needs
to be purchased, however. To make arrangements,
please contact Stacy in the office at 682-0504.

Spring Day Trip

Thursday, April 17th

9 am—4:30 pm

- * Bartlett Arboretum in Belle Plaine: Tour the Gardens—Enjoy the Tulips
- * Lunch: Luciano's Italian Restaurant in Mulvane
- * Wyldewood Cellars Winery, Mulvane
- * Tour the Allen-Lambe House, College Hill

All Inclusive Ticket Price: \$50

Register soon, space is limited. Payment due by March 31st. Cancellations after the registration due date cannot be refunded.



Upcoming Activities:



May 3: 3rd Annual Kentucky Derby Party
Larkfield Place

June 10: Social Luncheon

July 1: Matinee Encore Performance of
"The Return of Charlie Chan in
Graveyard Shift"
Holy Cross Lutheran Church

July 22: 24th Anniversary Luncheon
Grace Presbyterian Church

August 12: 7th Annual Greater Wichita
Senior Spelling Bee
Holy Cross Lutheran Church

September 9—October 28: FALL Session of
Adventures in Learning

MENU

We offer a buffet-style hot lunch with entertainment. Lunch reservations need to be made by Friday noon. (If you are bringing your own lunch, please call to reserve a seat.)

March 25

Meatloaf
Garlic Mashed Potatoes, Green Beans Almondine
Coleslaw, Biscuits
Chocolate Brownie

April 1

Chicken Marsala
Wild Rice Pilaf, Buttered Carrots
Garden Salad, Dinner Roll
Lemon Cake

April 8

BBQ Brisket
Scalloped Potatoes, Peas
Jello Salad, Bread
Cookie

April 15

Chicken Fried Steak
Cheesy Potatoes, Steamed Broccoli
Spinach Salad, Cornbread
Bread Pudding

April 22

Baked Ham
Sweet Potato Casserole, Garden Mix Vegetables
Tossed Salad, Dinner Roll
Chocolate Cake

April 29

Rosemary-Lemon Chicken
Couscous, Roasted Peppers and Corn
California Spring Mix Salad, Dinner Roll
Strawberry Shortcake

May 6

Smothered Beef Steak
Mashed Potatoes, French Yellow and Green Beans
Caesar Salad, Garlic Bread
Cookie

May 13

Grilled Chicken Sandwich
Pasta Salad, Chips
Cheesecake

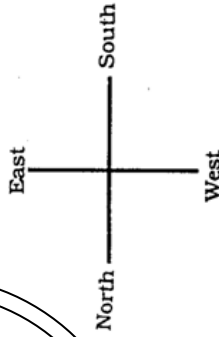

Questionable Weather??

If the Wichita Public School classes are cancelled, *Adventures in Learning* classes will be cancelled also.

- Check Facebook -

Parking is available on the east and south sides of East Heights United Methodist Church, the east side of Crestway Street, the parking lot of Second Church of Christ Scientist (east of East Heights).

The "no parking" area on the east side of the church is reserved for people taking young children to preschool. Please do not park in that area.

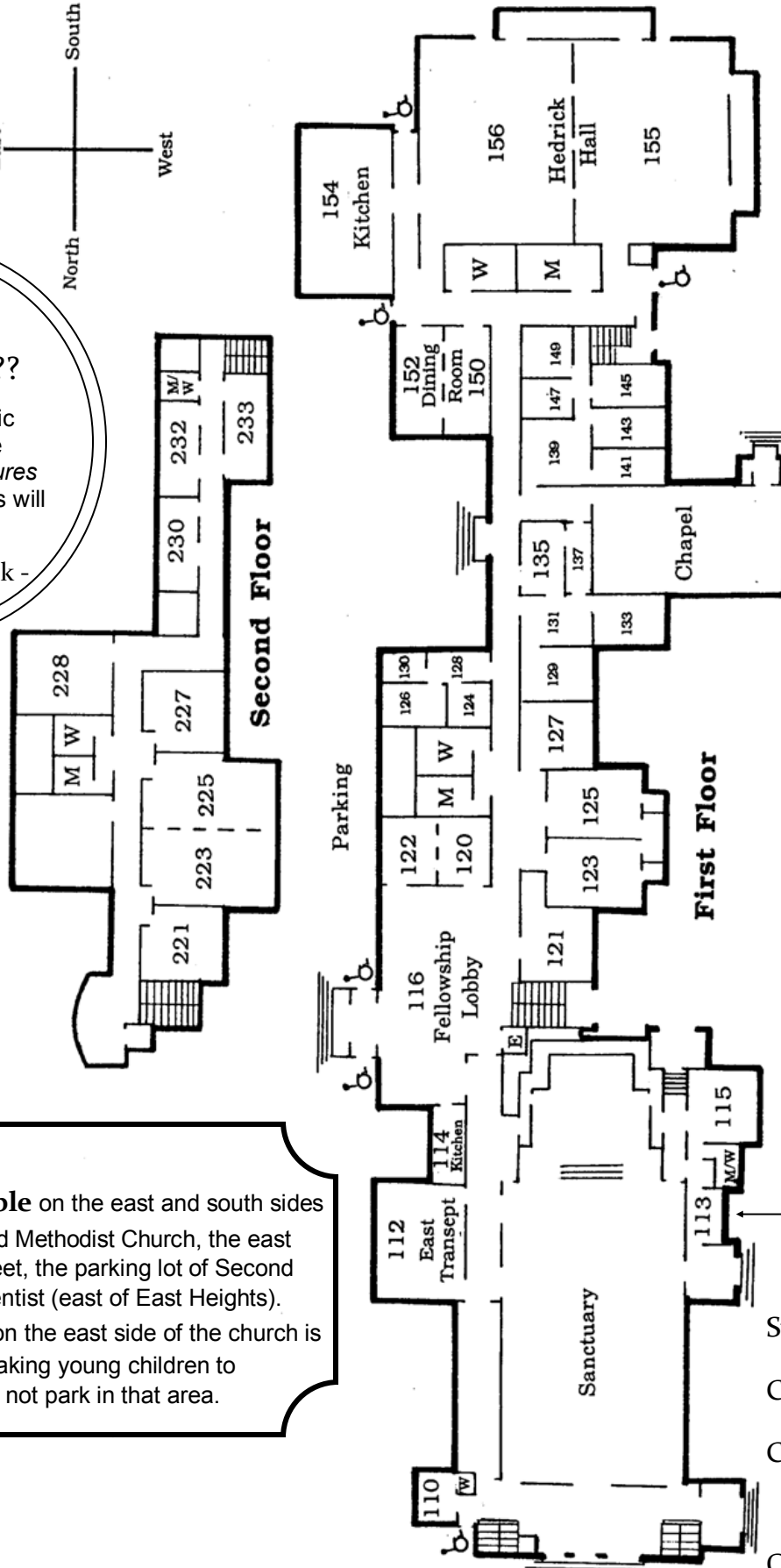

Crestway

LifeVentures Office

Stacy Jansson
Executive Director
Connilee Myers
Administrative Assistant
Carol Beverly
Adventures in Learning
Assistant

Office Hours:
Mon-Fri 9 AM—3 PM

East Douglas Avenue



Non-Profit Org.
U.S. Postage Paid
Wichita, KS
Permit No. 293

Energy for Your Thoughts!

4407 East Douglas Wichita, KS 67218 682.0504

Adventures in Learning

Spring 2014 Schedule
March 25—May 13, 2014



LifeVentures is a nonprofit, interfaith community of adults.

LifeVentures is a member of Shepherd's Centers of America.

Our Mission: To provide educational and enrichment opportunities for adults in an interfaith environment

Our Services: *Adventures in Learning* (education/activities) and social outings

Who does the work? Volunteers and the office staff

How is it financed? By donations, memorials, fundraisers, grants and *Adventures in Learning* fees

Where is it located? East Heights United Methodist Church, 4407 East Douglas, Wichita, KS 67218

We are blessed to have the support of these congregations:

East Heights United Methodist ~ Holy Cross Lutheran ~ Hillside Christian
Grace Presbyterian ~ St. James Episcopal ~ College Hill United Methodist
University Congregational ~ University United Methodist
First United Methodist ~ Plymouth Congregational ~ Temple Emanu-El
Lorraine Avenue Mennonite ~ Woodland Lakes Community

For more information, call the LifeVentures office at (316) 682.0504 Monday—Friday, 9 am to 3 pm
www.LifeVenturesKS.com



Like us on facebook