



## ADVENTURES IN LEARNING—Winter Session 2014

**REGISTRATION: \$60 if paid by January 1, \$65 after January 1.**

*Fees are nonrefundable. You may attend as many classes as you like in these eight weeks for one registration fee!*

**LUNCH FEE: \$8/week or \$60/eight weeks OR bring your own lunch and get a beverage and dessert for \$3.**

Lunch reservations need to be made and paid **in advance by Friday noon.**

~ 8:15—8:45 am ~

**Blood Pressure Check in the North Hallway**

*by Wichita Parish Nurse Ministry. Please allow enough time so everyone can get to class.*

Jette Mortensen, R.N., Parish Nurse

**Coffee and Conversation in the Lobby**

~ 9:00—9:50 am ~

### TRAVEL

**Jan. 7** “Fossils in Kansas—Two Bit Ranch”

Joe & Ardis Cruze, Owners, Two Bit Ranch

**Jan. 14** “Black Sea and Crimean Coast”

Karen Malcom and Pat DeVoss, Retired

**Jan. 21** “Egypt: Land of Exciting Contrasts”

Crystal Diamond, President, Crystal Light Tours, Inc.

**Jan. 28** “Proposed Rail between Wichita and Oklahoma City”

Pete Meitzner, Vice Mayor, Councilman, Wichita

**Feb. 4** “Thirty Years of Travel in France”

Carol Webb, French Teacher, Retired

Eunice Ellis, Educator, Editor, Business Woman, Retired

**Feb. 11** “Travel to the Mediterranean”

Vic Heckart, Project Engineer, Honeywell Aerospace, Retired; Ruth Heckart, Photographer

**Feb. 18** “Portland, Oregon and Coastal Area”

Paulette Mattingly, Office Mgr., Asst. Funeral Director, Retired, Photographer

**Feb. 25** “Turkey”

Halil I. Cobuloglu, President, IIE-WSU Chapter, WSU

### HEALTH

**Jan. 7** “A Tree Falling in the Forest: the Silent Generation and Mental Health”

Ron Leupp, Independent Consultant

**Jan. 14** “Senior Care Opportunities”

Susan Kiefer, Always Best Care Senior Services of the Heartland

**Jan. 21** “The Way You Want to Live—Senior Living Options”

Amy Watson, Senior Living Counselor, Presbyterian Manor

~ 9:00—9:50 am ~

**Jan. 28** “Aromatherapy and Arthritis”

Julie Sharp, Aromatherapist

**Feb. 4** “Hospice Facts/Fiction & the Need for Volunteers”

Randall Turner, Mark Davis, Cathy Parry-Jones, Harden Hospice—Kansas/Missouri

**Feb. 11** “Health Laws and Concerns in Kansas”

Carol Neale, President, League of Women Voters, Wichita-Metro

**Feb. 18** “Relaxation Techniques”

Meg Beck, Music Therapist, Larksfeld Place

**Feb. 25** “Kansas Telecommunications Access Program”

Tim Anderson, Coordinator, Kansas TAP

### BRIDGE CONVENTIONS

**Jan. 7—Feb. 25** A class targeting bridge players who wish to learn basic conventions with an eye to playing duplicate contract bridge. Regular partners welcome. Limit: 8

Alan Phares, American Contract Bridge Life Master

~ 10:00-10:50 am ~

### RELIGION

**Jan. 7—Feb. 25** “The Gospel of John”

Rev. Paul Reimers, Lutheran Pastor, ELCA, Retired

**Jan. 7** “Ch 1:1-42: The Word Made Flesh”

**Jan. 14** “Ch 1: 43-51, Ch 2: Jesus’ First Disciples, Wedding at Cana, Cleansing of the Temple”

**Jan. 21** “Ch 3: Jesus and Nicodemus: God So Loved the World”

**Jan. 28** “Ch 4: Jesus and the Woman at the Well”

**Feb. 4** “Ch 5, 6, 7: Jesus Heals the Paralyzed Man; Jesus Feeds the 5000; Jesus says, ‘I Am the Bread of Life’”

**Feb. 11** “Ch 8, 9: Jesus says, ‘I Am the Light of the World’; Jesus Heals the Man Born Blind”

**Feb. 18** “Ch 10: Jesus says, ‘I Am the Door of the Sheep, I Am the Good Shepherd, I and the Father Are One’”

**Feb. 25** “Ch 11: Jesus Raises Lazarus from the Dead; Jesus says, ‘I Am the Resurrection and Life’”

~ 10:00-10:50 am ~

## HISTORY

- Jan. 7** "Story of 'Home on the Range'"  
Ken Spurgeon, Teacher, Filmmaker, Historian
- Jan. 14** "JFK's Assassination: Still a Mystery after 50 Years"  
Carl Williams, Photographer, Moviemaker
- Jan. 21** "Notorious Pirates: Anne Bonny and Mary Read"  
Jillian Overstake-Forsberg, Educational Director, Museum of World Treasures
- Jan. 28** "The Myth and the Man: Howard Hughes"  
Cory Fuqua, Director of Education, Kansas Aviation Museum
- Feb. 4** "*Captain Tough, Chief of Scouts*"  
Charles F. Harris, Author, Attorney-at-Law
- Feb. 11** "My Mother's Journey; History of Orphan Trains"  
Mardella Freund, Tour Guide, Volunteer, Botanica
- Feb. 18** "Bronco Bustin' Showmen: Cowboy Entertainers of Northeast Oklahoma"  
Jane Glotfelty Rhoads, Student Success Learning Specialist, WSU, Author
- Feb. 25** "Erma Bombeck: a Lady of Great Humor"  
Loretta Lyon, Educator, Retired

## ART APPRECIATION

- Jan. 7** "CityArts—Programs Available to the Public"  
Marilee Mitchell, Artistic Director, CityArts
- Jan. 14** "'Tea with Ted': film and discussion"  
Glenn Fillmore, Professional Photographer
- Jan. 21** "Photo Tips"  
Barney Tull, Award-Winning Photographer, Retired
- Jan. 28** "Discussion and Critiques of Participants' Photos"  
Barney Tull, Award-Winning Photographer, Retired
- Feb. 4** "3-D Ceramic Pet Tiles"  
Sondra Alexander, Certified Flight Instructor, Artist
- Feb. 11** "Forty-Something Paintings"  
Lisa Graham, Artist
- Feb. 18** "Zentangle"  
Bonnie Peweterbaugh, Certified Zentangle Teacher
- Feb. 25** "Fun Things to Do with Your Photos"  
Paulette Mattingly, Office Mgr., Asst. Funeral Director, Retired, Photographer

## SING!

- Jan. 7—Feb. 25** "Singing for Fun"  
Glennyce Reimers, Parish Choir Director, Reformation Lutheran Church

~ 10:00—10:50 am ~

## POETRY

- Jan. 7—Feb. 25** "Poetry and Sound"  
Roy Beckemeyer, Poet

~ 11:00—11:50 am ~

## WHAT HAVE YOU READ LATELY?

- Jan. 7** "*An American Woman's Zest for Living*"  
Donna Dilsaver, Author
- Jan. 14** "*Lady Almina and the Real Downton Abbey: The Lost Legacy of High Clere Castle* by The Countess of Carnarvon"  
Glennyce Reimers, Avid Reader, Retired
- Jan. 21** "*Airplane Beans*"  
Harold Walter, Aerodynamics Consultant, Author, Retired
- Jan. 28** "*The Children's Nativity with Family Devotions and Activities*"  
Marti McCartney, Author, Living History Interpreter
- Feb. 4** "*The Wonderful Wizard of Oz* by L. Frank Baum"  
Jean Hatfield, Branch Manager, Lionel D. Alford Library, Wichita Public Library
- Feb. 11** "*Orphan Trains: The Story of Charles Loring Brace and the Children He Saved and Failed* by Stephen O'Connor"  
Dee Smith, Poet, Author, Book Reviewer
- Feb. 18** "*Discover Your Optimal Health* by Dr. Wayne Scott Andersen"  
Doris Cannon, Independent Certified Health Coach with Take Shape for Life
- Feb. 25** "*The 5 Love Languages: the Secret to Love That Lasts* by Gary Chapman"  
Jan Schmidt, English Teacher, Retired

## POTPOURRI

- Jan. 7** "I'm Not Crazy—I Have a Syndrome!"  
Peggy Sampson, Outreach Coordinator; Audio-Reader, Service for Blind and Print-Disabled Persons
- Jan. 14** "What AARP Does in Kansas"  
Mr. & Mrs. Gerald Schmitt, KS Area Volunteers
- Jan. 21** "Where Cases Are Filed and Why"  
Jamie Haig, Wichita Division Mgr., U.S. District Court
- Jan. 28** "PODS: Portable On Demand Storage"  
Ed Azar, Owner, PODS
- Feb. 4** "Past, Present, Future of the Orpheum"  
Jennifer Wright, President, Orpheum Theatre
- Feb. 11** "Dealing in Collectible Cars"  
Don Damon, Car Dealer, Lottery Winner
- Feb. 18** "African Americans' History is Everybody's History"  
Christyn Breathett, Education Director, African American Museum

~ 11:00—11:50 am ~

**Feb. 25** “History of the Junior League of Wichita”  
Emily Thengvall, President, Junior League of Wichita

## THREADBARE READERS THEATRE

**Jan. 7—Feb. 25** Join a fun group rehearsing short skits and sketches for public presentations. No memorization is needed but good public reading/ speaking is important.  
Ed Thompson, Drama Teacher, Minister, Retired

## COMPUTERS

**Jan. 21-Feb. 11** “The Internet: Basic and Helpful— Let’s Use It!”  
Doris Cannon, Program Education Specialist, WSU, Retired  
**Jan. 21** “Tech Savvy Seniors—Terms You Should Know”  
**Jan. 28** “Shopping On-line”  
**Feb. 4** “YouTube / Pinterest / Craigslist”  
**Feb. 11** “Household Management: On-line Banking, Paying Bills, E-Coupons”

~ 12:00—12:40 LUNCHEON ~

~ 12:45—1:20 pm PROGRAM ~

**Jan. 7** “High-Powered Rocketry”  
Monta Plank, KLOUDbusters, Tripoli Rocketry Assoc.  
**Jan. 14** “Bartlett Arboretum—Uncommon Ground”  
Robin Macy, Steward, Bartlett Arboretum  
**Jan. 21** “Our Winery: What We Do!”  
Merry Bauman, Proprietor, Wyldewood Cellars Winery  
**Jan. 28** “A Variety of Songs—My Solo Style”  
Charles Nida, Professional Vocalist, Guitarist  
**Feb. 4** “Kansas Food Bank: Compassionate Hunger Care”  
Debbie Kreutzman, Community Relations Manager, Kansas Food Bank  
**Feb. 11** “Threadbare Readers Theatre of LifeVentures”  
**Feb. 18** “Music for the Soul—Blues and Praise”  
BigG Mac Combo: Gerry McCann, Larry Roberts, Mike Estep  
**Feb. 25** “Air Capital Active People: On the Road Again”  
Dennis & Ara Ann Duty, Members, ACAP

~ 1:30—2:20 pm ~

## RELIGION (Repeat of Morning Session)

**Jan. 7—Feb. 25** “The Gospel of John”  
Rev. Paul Reimers, Lutheran Pastor, ELCA, Retired

Join Us for a Holiday Excursion:

## Central Community Christmas

Sunday, Dec. 15  
6:00 pm

Contemporary Band & Singers  
The Christmas Story  
Festival Orchestra

Central Community Church, 6100 W. Maple St.

Admission is free

*For carpooling info:  
please call the office @ 682.0504*

## Scholarships Available for WINTER SESSION

LifeVentures has scholarships available for *Adventures in Learning* through the Bill & Shirley Nail Memorial Scholarship Fund.

The purpose is to help individuals pay the registration fee —up to \$30 (or half the fee). Please contact Stacy Jansson to apply for one of these scholarships.

This fund is separate from the general budget. Donations honor the Nails and extend our group.



LifeVentures welcomes guests. You may bring a friend (*first-time attendee only*) to classes one Tuesday with no fee. Lunch needs to be purchased, however. To make arrangements, please contact Stacy in the office at 682-0504.

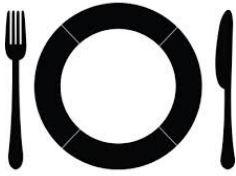

**LUNCHEON TICKETS** are to be reserved and paid for by Friday noon prior to the luncheon of the next week. Tickets are to be picked up the morning of the luncheon. At the time of pick-up, reservations for the following week may be made.

Payment must be made at that time.

An exact count of paid lunches is reported to the caterer on Friday afternoon.

Cancellations, likewise, must be made before Friday noon. When payment is made for a particular lunch date, it may be applied to a later luncheon if the request has taken place by Friday noon.

Should an inclement weather day cancel *Adventures in Learning*, paid lunches will be forfeited. The caterer still needs to be paid partial/full payment, depending on the food that was ordered or prepared. Any prepared food is donated to the Lord's Diner and/or the Kansas Food Bank.

Luncheon tickets may be purchased at the lunch-room door only if there have been cancellations.

# curious

• **SPRING Session will be March 25—May 13. Join Us!**

LifeVentures relies on financial support from *Adventures in Learning* fees, donations, memorial contributions, fundraisers and grants to help reduce deficits and pay expenses. LifeVentures is a private, not-for-profit entity.



In the spirit of giving this holiday season, please consider a donation. Gifts given in honor, memory or appreciation of someone special to you are welcomed. Express your admiration or appreciation as a tribute gift to LifeVentures. We will send a card to the person you are recognizing, or the family of someone being remembered. (The amount is not mentioned in the card sent.) Thank You for your consideration!

## MENU

We offer a buffet-style hot lunch with entertainment. Lunch reservations need to be made by Friday noon. (If you are bringing your own lunch, please call to reserve a seat.)

### January 7

Smothered Beef Steak  
Scalloped Potatoes, Corn  
Tossed Salad, Dinner Roll  
Cookie

### January 14

Barbeque Chicken  
Couscous, Steamed Mixed Vegetables  
Cole Slaw, Garlic Bread  
Brownie

### January 21

Oven-Roasted Turkey  
Garlic Mashed Potatoes, Green Beans  
Jello Salad, Dinner Roll  
Lemon Cake

### January 28

Ham with Pineapple Sauce  
Sweet Potato Casserole, Buttered Peas  
Spinach Salad, Biscuit  
Chocolate Cake

### February 4

Chicken Cacciatore  
Pesto Pasta  
Caesar Salad, Garlic Bread Stick  
Bread Pudding

### February 11

Hamburger with Lettuce and Tomato  
Crunchy Tater Tots  
California Spring Mix Salad  
Cheesecake

### February 18

Chicken Alfredo  
Fettuccine Pasta, Capri Vegetable Blend  
Italian Garden Salad, Bread  
Pudding Cup

### February 25

Ham & Egg Casserole  
Steamed Vegetables  
Fresh Fruit Salad  
Cookie

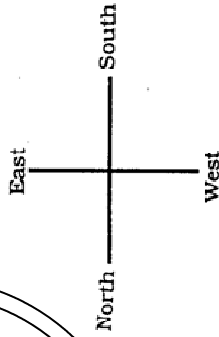

**Questionable Weather??**

If the Wichita Public School classes are cancelled, *Adventures in Learning* classes will be cancelled also.

- Check Facebook -

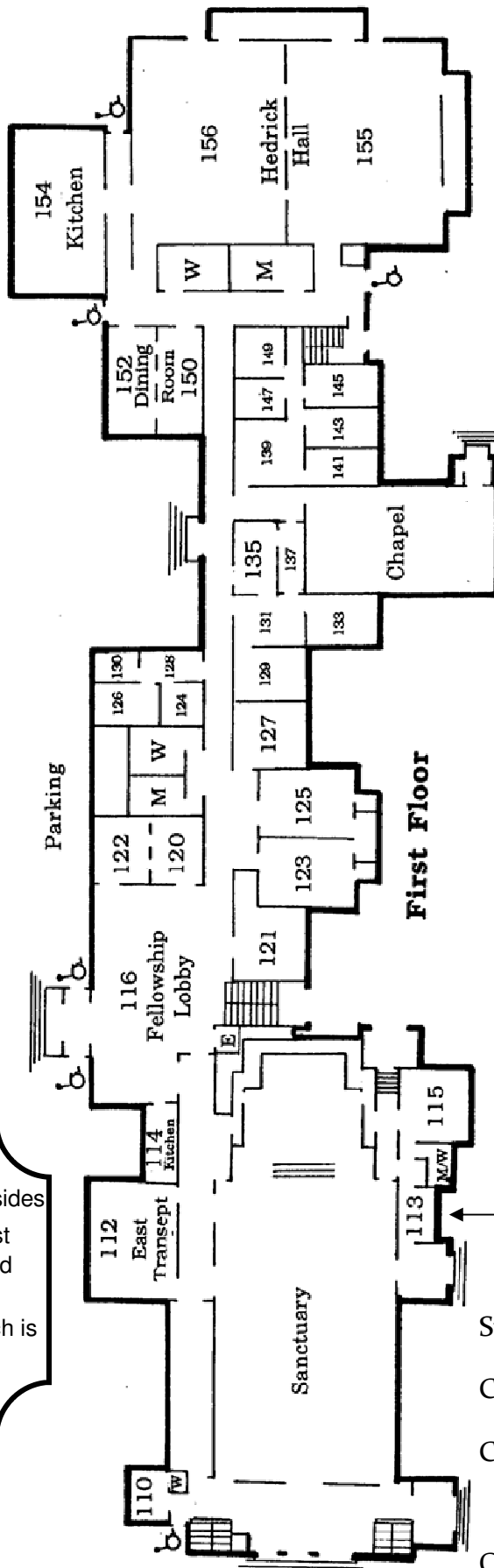
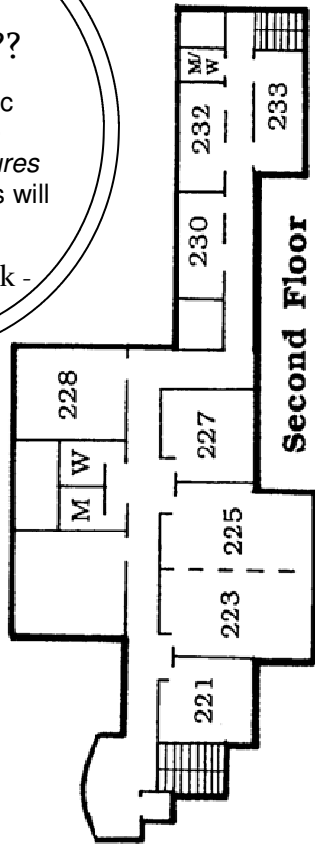

**Parking is available** on the east and south sides

of East Heights United Methodist Church, the east side of Crestway Street, the parking lot of Second Church of Christ Scientist (east of East Heights).

The "no parking" area on the east side of the church is reserved for people taking young children to preschool. Please do not park in that area.

LifeVentures Office  
 Stacy Jansson  
 Executive Director  
 Connilee Myers  
 Administrative Assistant  
 Carol Beverly  
*Adventures in Learning*  
 Assistant

Office Hours:  
 Mon-Fri 9 AM—3 PM

East Douglas Avenue

Rub elbows with the insatiably

CURIOUS.



LifeVentures

Your place to keep knowing & growing

4407 East Douglas Wichita, KS 67218 682.0504

Non-Profit Org.  
U.S. Postage Paid  
Wichita, KS  
Permit No. 293

## Adventures in Learning

Winter 2014 Schedule  
January 7—February 25, 2014

LifeVentures is a nonprofit, interfaith community of adults.

LifeVentures is a member of Shepherd's Centers of America.

**Our Mission:** To provide educational and enrichment opportunities for adults in an interfaith environment

**Our Services:** *Adventures in Learning* (education/activities) and social outings

**Who does the work?** Volunteers and the office staff

**How is it financed?** By donations, memorials, fundraisers, grants and *Adventures in Learning* fees

**Where is it located?** East Heights United Methodist Church, 4407 East Douglas, Wichita, KS 67218

We are blessed to have the support of these congregations:

East Heights United Methodist ~ College Hill United Methodist ~ Holy Cross Lutheran ~ Hillside Christian  
Grace Presbyterian ~ St. James Episcopal ~ University Congregational ~ University United Methodist  
First United Methodist ~ Plymouth Congregational ~ Temple Emanu-El ~ Lorraine Avenue Mennonite

For more information, call the LifeVentures office at (316) 682-0504 Monday—Friday, 9 am to 3 pm

[www.LifeVenturesKS.com](http://www.LifeVenturesKS.com)



Like us on facebook